

# SHOCK ASSEMBLY INSTRUCTIONS

## STEP 1

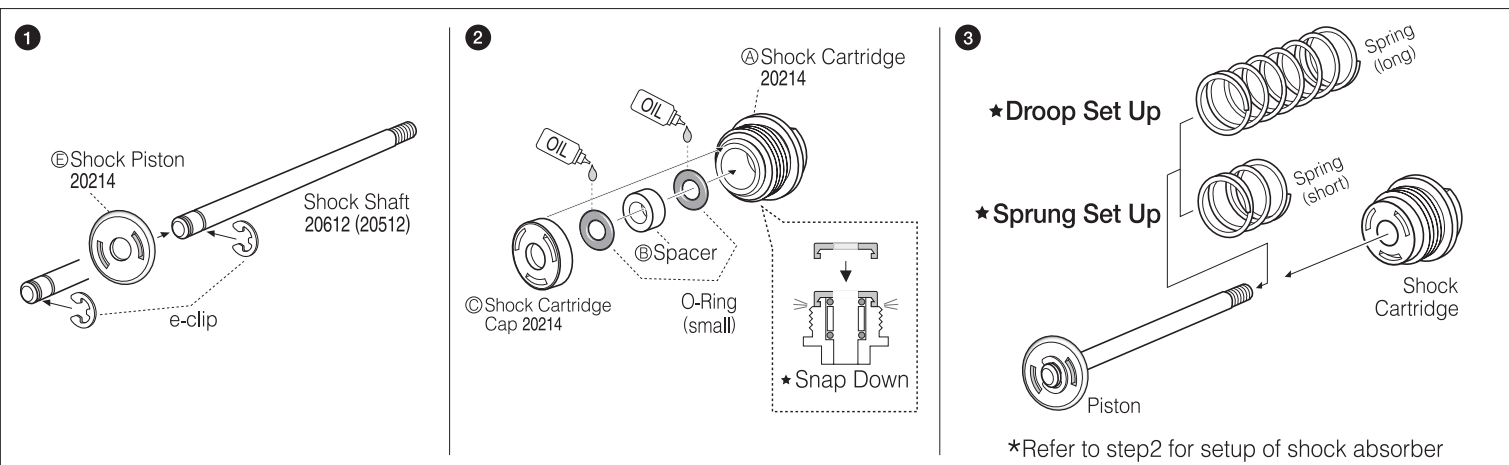
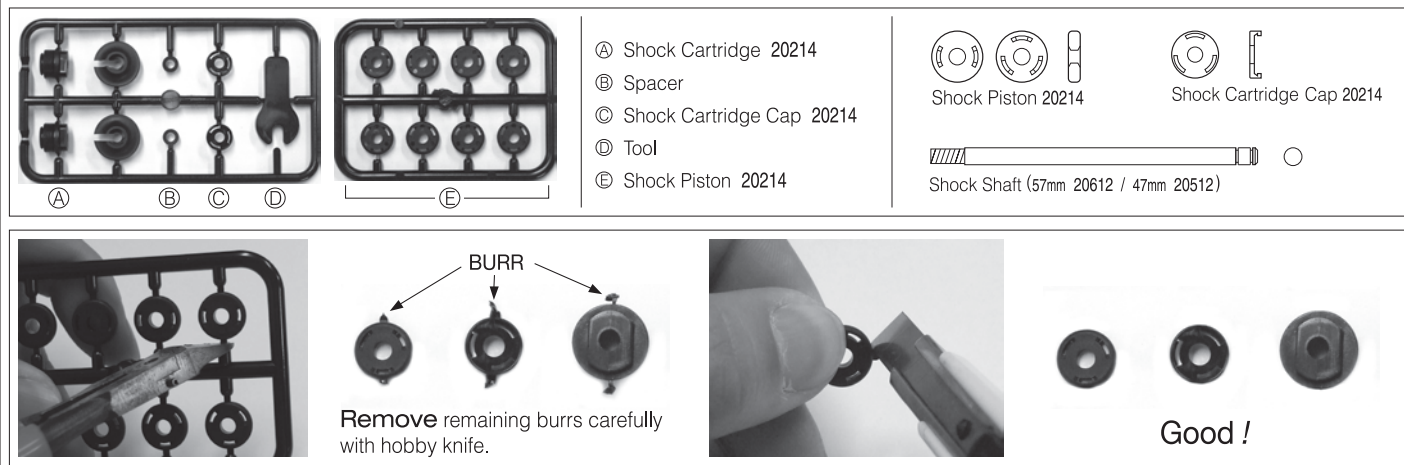

## STEP 2 For Droop Set Up

This setup can help when your car is needed to have a slammed stance and low Center of Gravity.

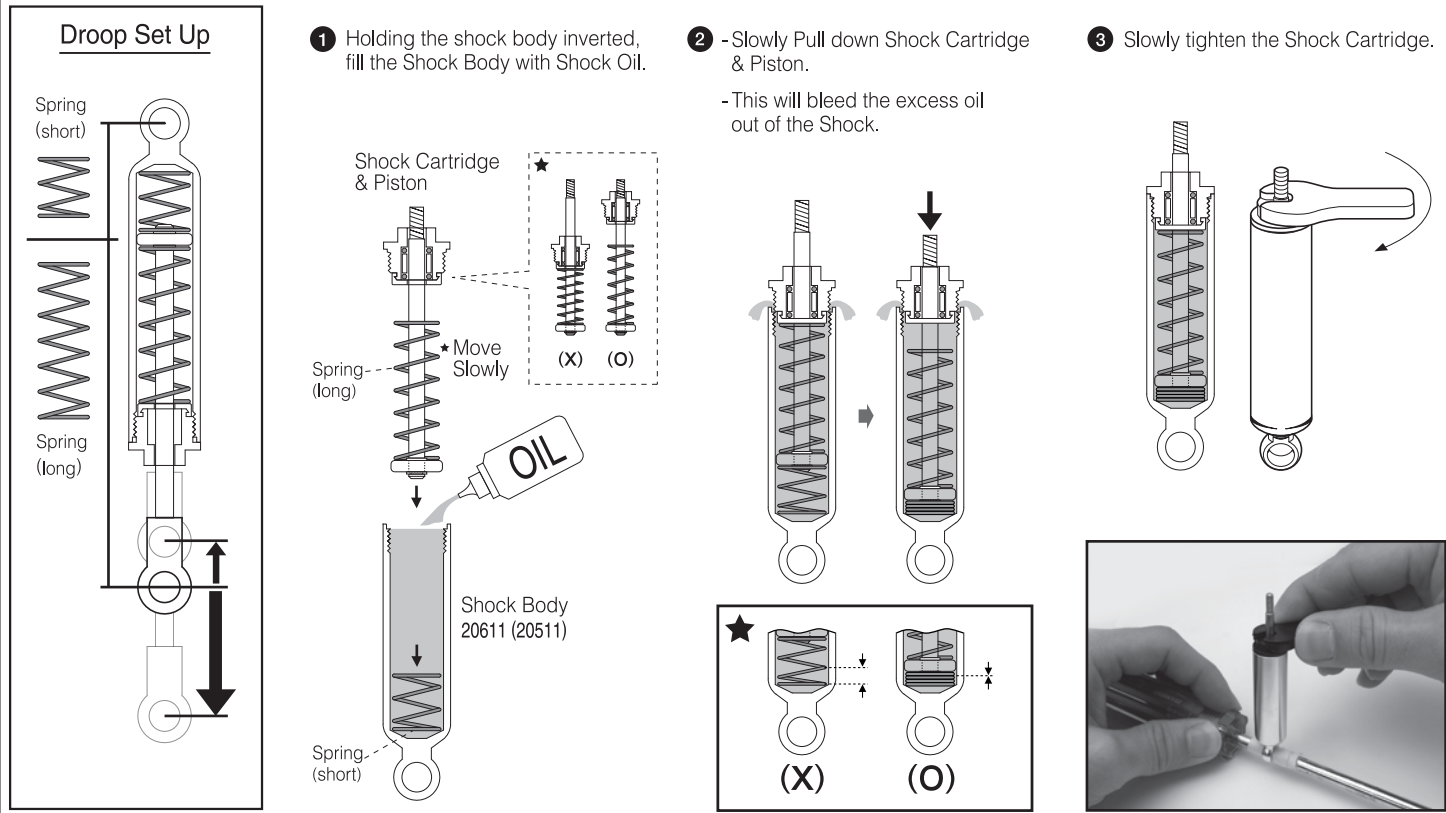

## STEP 2 For Sprung Set Up

This setup can make you have an advantage on rocks or steps as high as wheelbase.

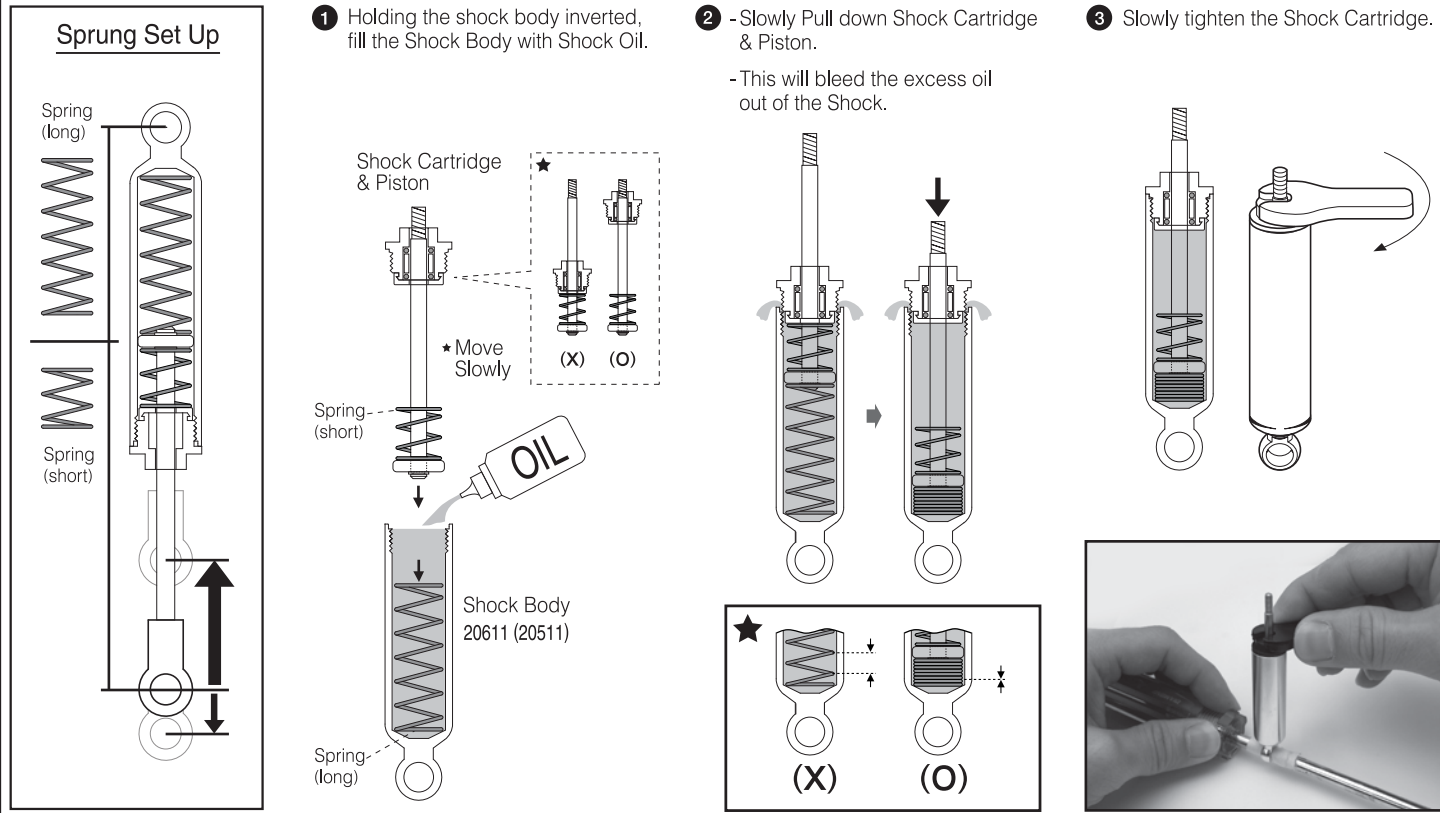

## STEP 3

